

> CABLE 3 MM / 3 MM CABLE COMPONENTS



C3100

KIT POUR FIXATION SOL-PLAFOND (4 MÈTRES)

- Fixation haute Ø 18,5 mm
- Câble en acier inoxydable L. 4 m
- Fixation basse avec tendeur

(Clé Allen et vis fournies avec le Kit)

FLOOR / CEILING FIXING KIT (4 METRES)

- 18,5 mm Ø top fixing
- 4 m stainless steel cable
- Floor anchor with adjusting sleeve

(Allen key and fixing screws supplied)



C3102

KIT PIVOT AVEC PLATINE (4 MÈTRES)

- Platine Ø 34,5 mm
- Fixation haute à pivot Ø 18,5 mm
- Câble en acier inoxydable L. 4 m
- Fixation basse à pivot avec tendeur
- Projection 32 mm

(Clé Allen et vis fournies avec le Kit)

WALL MOUNTED SWIVEL KIT WITH PLATE (4 METRES)

- Plate / 34,5 mm Ø
- Top swivel fixing / 18,5 mm Ø
- 4m stainless steel cable
- Lower swivel fixing with adjusting sleeve
- 32 mm projection

(Allen key and fixing screws supplied)



C3109

KIT PIVOT SANS PLATINE (4 MÈTRES)

Montage modulable sur rail

WALL MOUNTED SWIVEL KIT WITHOUT PLATES (4 METRES)

Modular assembly on rail

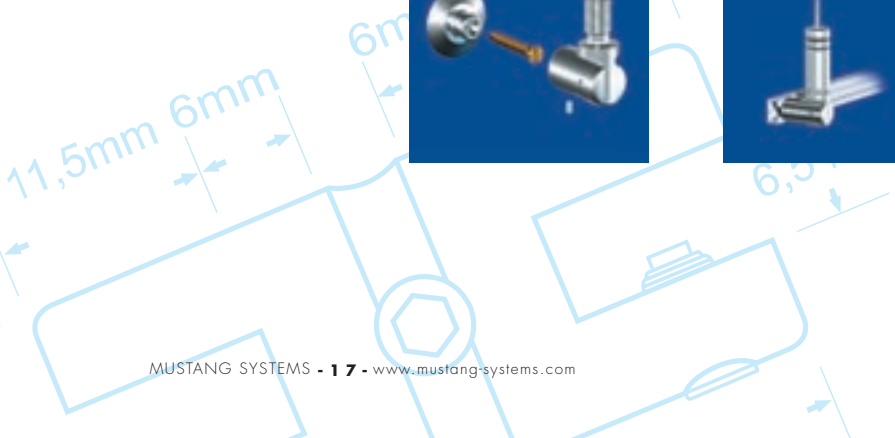

> CABLE 3 MM / 3 MM CABLE COMPONENTS

6 mm



C3201

SUPPORT POUR PANNEAU JUSQU'À 6 mm

PANEL SUPPORT FOR UP TO 6 mm

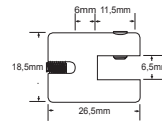

C3203

SUPPORT DOUBLE POUR PANNEAU JUSQU'À 6 mm

TWIN PANEL SUPPORT FOR UP TO 6 mm

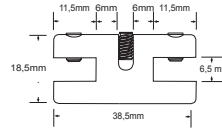

10 mm



C3202

SUPPORT POUR PANNEAU JUSQU'À 10 mm

PANEL SUPPORT FOR UP TO 10 mm

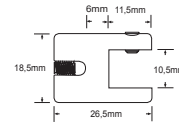

C3204

SUPPORT DOUBLE POUR PANNEAU JUSQU'À 10 mm

TWIN PANEL SUPPORT FOR UP TO 10 mm

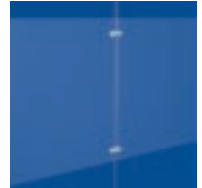
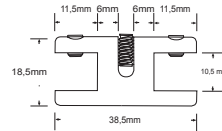

C3401

SUPPORT SUPÉRIEUR OU INFÉRIEUR
POUR PANNEAU JUSQU'À 10 mm

PANEL SUPPORT TOP OR BOTTOM
FOR UP TO 10 mm

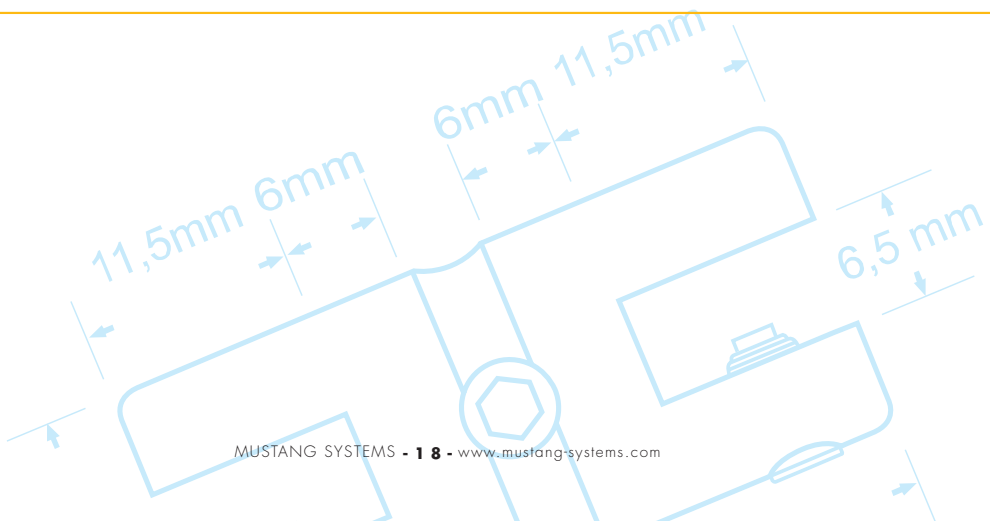
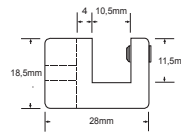

> CABLE 3 MM / 3 MM CABLE COMPONENTS



C3300

SUPPORT POUR TABLETTE PERCEE / PERCAGE Ø 10 mm

PIERCED SHELF SUPPORT / 10 mm Ø HOLE FIX

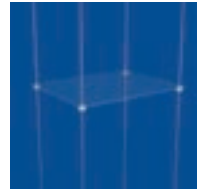
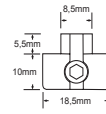

C3301

SUPPORT POUR TABLETTE JUSQU'A 6 mm

SHELF SUPPORT FOR UP TO 6 mm

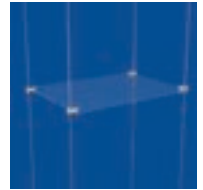
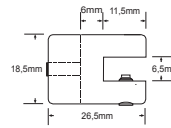

C3303

SUPPORT DOUBLE POUR TABLETTE JUSQU'A 6 mm

TWIN SHELF SUPPORT FOR UP TO 6 mm

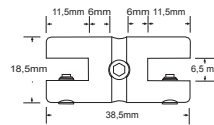

C3302

SUPPORT POUR TABLETTE JUSQU'A 10 mm

SHELF SUPPORT FOR UP TO 10 mm

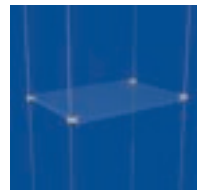
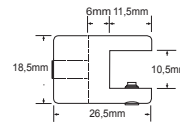

C3304

SUPPORT DOUBLE POUR TABLETTE JUSQU'A 10 mm

TWIN SHELF SUPPORT FOR UP TO 10 mm

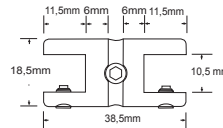

C3306

CONSOLE POUR TABLETTE JUSQU'A 8 mm
- Finition Aluminium brossé / épaisseur 2 mm

SHELF CONSOLE FOR UP TO 8 mm
- Brushed Aluminium finish / 2 mm thickness

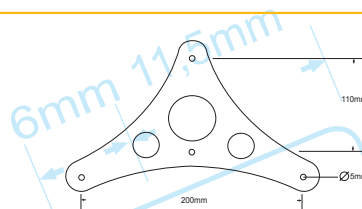

6 mm

10 mm

8 mm

> CABLE 3 MM / 3 MM CABLE COMPONENTS

8 mm

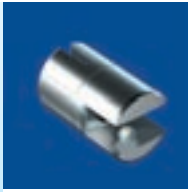

C3600

SUPPORT ORIENTABLE POUR LUTRIN, PANNEAU ET TABLETTE
JUSQU'À 8 mm

SWIVEL LECTURN, PANEL AND SHELF SUPPORT
FOR UP TO 8 mm

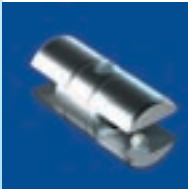
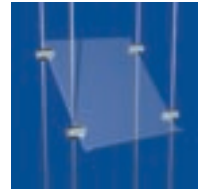
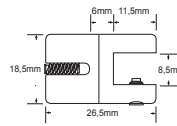

C3601

SUPPORT DOUBLE ORIENTABLE POUR LUTRIN, PANNEAU
ET TABLETTE JUSQU'À 8 mm

TWIN SWIVEL LECTURN, PANEL AND SHELF SUPPORT
FOR UP TO 8 mm

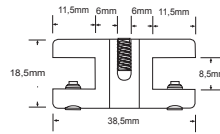

Pour bloquer l'orientation, supprimer la bague en laiton.

To prevent the rotation of the support, remove the brass ring.

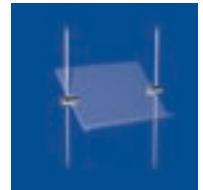

C3400

SUPPORT DE CADRE

FRAME SUPPORT

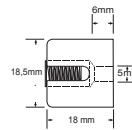

de 4 à 6 mm



C3407

SUPPORT POUR PANNEAU PERCE / PERÇAGE Ø 5 mm

PIERCED PANEL SUPPORT / 5 mm Ø HOLE FIX

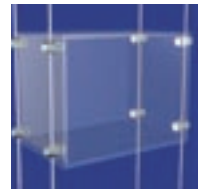
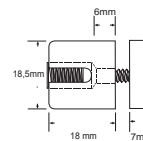

C3409

SUPPORT DOUBLE POUR PANNEAU PERCE / PERÇAGE Ø 5 mm

TWIN PIERCED PANEL SUPPORT / 5 mm Ø HOLE FIX

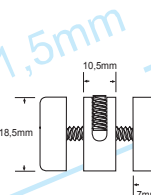

> CABLE 3 MM / 3 MM CABLE COMPONENTS



C3404

TUBE HORIZONTAL & 2 SUPPORTS / L. 1 MÈTRE
 - Tube Ø 16 mm
 - Finition Aluminium anodisé

HORIZONTAL TUBE & 2 SUPPORTS / L. 1 METRE
 - 16 mm Ø tube
 - Anodized Aluminium finish

Autres dimensions : nous consulter / Other dimensions : consult us

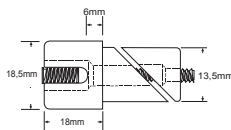

C3410

BARRE PENDERIE / L. 1 MÈTRE
 - Tube Ø 25 mm / 2 serre-câbles / 2 embouts de finition
 - Finition Acier chromé

HANGING RAIL / L. 1 METRE
 - 25 mm Ø tube / 2 cable-grips / 2 finishing caps
 - Steel chrome finish

Autres dimensions : nous consulter / Other dimensions : consult us

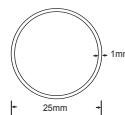

C3403

SUPPORT CROCHET INOX

HOOK SUPPORT

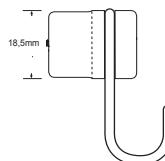

C3408

SUPPORT DOUBLE CROCHET INOX

TWIN HOOK SUPPORT

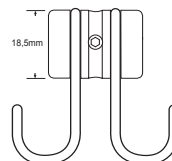

C3701

SERRE-CABLE POUR CÂBLE Ø 3 mm

CABLE GRIP for 3 mm Ø CABLE

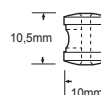

BOBINE DE CABLE INOXYDABLE / Ø 3 mm - STAINLESS STEEL CABLE / ROLL 3 mm Ø

<p>C3504</p> <p>L. 10 M / CABLE INOXYDABLE L. 10 M / STAINLESS STEEL CABLE</p>	<p>C3505</p> <p>L. 25 M / CABLE INOXYDABLE L. 25 M / STAINLESS STEEL CABLE</p>	<p>C3506</p> <p>L. 50 M / CABLE INOXYDABLE L. 50 M / STAINLESS STEEL CABLE</p>	<p>C3507</p> <p>L. 100 M / CABLE INOXYDABLE L. 100 M / STAINLESS STEEL CABLE</p>
--	--	--	--



C3712

DISQUE CACHE-PLAFOND

CEILING SHIELD

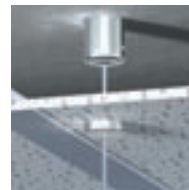
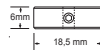

C3101

FIXATION PLAFOND AVEC SERRE-CABLE

TOP FIXING WITH CABLE GRIP

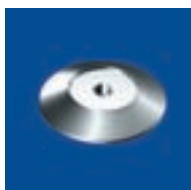
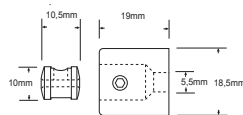

C1702

PLATINE DE FINITION

FINISHING PLATE

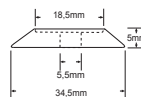

C1710

FIXATION POUR RAIL (M 4)

RAIL SUPPORT (M 4)

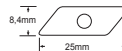

C1711

RAIL FIXATION SOL-PLAFOND (2 MÈTRES)

- Finition Aluminium anodisé

FLOOR / CEILING FIXING RAIL (2 METRES)

- Anodized Aluminium finish

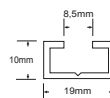

Pour implantation modulaire / For modular set up

