

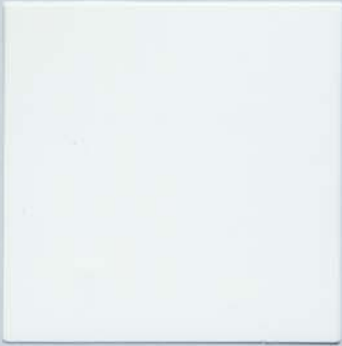

■ meng guidance and orientation systems



Designpreis der
Bundesrepublik
Deutschland
2002

Our signposting and labelling systems have been awarded many prizes for their design, giving us an even greater incentive to continue finding new ways to combine technical quality with inspired design.



For over fifteen years Meng has been developing and producing sophisticated solutions in the conception, planning and manufacture of guidance and orientation systems which fully complement the specific architectural styles in which they are located.

An important element of our work is developing new components which integrate the latest state-of-the-art technical standards. As well as being able to provide total systems as a package, we are also always willing to collaborate on interdisciplinary projects with planners, designers, agencies, graphic designers and clients.

quintessence

The »quintessence« system creates an opportunity for planners, architects and building owners to employ a discreet informational medium which will adapt to any architectural style. The content and the graphic design play the major role in this system, whilst the actual texts are easy to exchange and safely held in practical frameless clamps.

system seven

In »system seven«, slim shapes and vaulted surfaces provide light and transparent elements, which are especially effective in collaboration with modern architectural styles. Mobile informational elements, for which the text can be compiled by EDP systems, offer the utmost flexibility.

tube+panel

Our »tube+panel« system is ideal wherever a signposting system is required which needs to combine the highest quality with the potential for universal application. Continual advances and developments in this system have resulted in a wide range of solutions based on standard elements. By means of profiles and system components, elements are created which far exceed the capabilities of other simple signposting systems.

transparence

The »transparence« system integrates glass and acrylic surfaces in a modern informational medium with a high aesthetic appeal and an almost weightless clarity. The innovative holder elements provide elegant yet reliable support.

tailor-made

Due to their modular nature, Meng systems offer standardised and thus low-cost solutions for a range of situations. But when special challenges require individually designed informational elements, we are able to use our unparalleled depth of technical and conceptual expertise in the areas of design, construction and material processing. »tailor-made« is an essential aspect of our work, giving form and shape to our clients' ideas, and joining forces with customers to find new solutions.

Consultation
Project analysis
Planning
Design
Installation
Project recording





The planning phase starts with an analysis of the objective data and of the intended routing and guiding. Face-to-face meetings help determine the precise demands, specify the user groups and set the targets to be achieved.

In co-operation with the building owners, planners and the subsequent users of the building, our expert consultants define the demands, determine the locations for signs to be sited, and create solutions for special situations.

When the appropriate system has been selected, the graphic design for the elements may be created by external designers, or within our in-house graphics department. All designs are presented in small scale for pre-production approval.

Our skilled and well-trained staff install the elements on site with the utmost care and attention to detail – and within the deadlines. We seek to guarantee true customer satisfaction in all the fields of our enterprise.

By recording all information on each signposting project after its completion, we thus guarantee precise and identical elements, even in the case of repeat orders after several years have elapsed.



tube+panel

smart center, worldwide

- 1 smart-logo as raised signature composed from individual letters
- 2 Ceiling-suspended banner as room-separating elements, anodised system profiles in silver colour, polyester webbing
- 3 Stand-alone illuminated box element »Triptych«, for inserting inlays onto both sides, profiles and body anodised in silver colour
- 4 Stand-alone display, steel foot plate, silver anodised aluminium profiles, DIN A 4 quick-change frame
- 5 »Felgenpräsentier«, anodised in silver colour

Photos by smart GmbH



A new brand is created. Its image must be presented identically and consistently throughout Europe, thus an innovative concept needs to be developed.

Such a project produces many different demands – including continually changing tasks, narrow trade fair schedules, and high aesthetic standards – requiring not only a highly flexible signposting system, but also the necessary technical and organisational requirements for its implementation.



system seven
FFG, Hamburg

- 1 Pillars of the exterior guiding system, aluminium, anodised, silver colour
- 2 Pillar as object identification with cutout, backlit logo in the vaulted metal surface
- 3 Large object stele
6,000 x 1,450 mm
Photos by Peter Behrendt
- 4 Signpost directory with site plan and legend, screen print
- 5 Visitors' letterbox, customised as element for system seven pillar, opens via hinges, with card case, accessible from both sides, labelled in German/English
Photos by Igel Studios

In harmony with the surrounding architecture, exterior pillars provide the dominating visual element. Thus by day and night a company's different sections are clearly structured and entrances are easily identified.

The International Centre for Communication and Training for the Printing Industry exhibits a vivid and interesting architecture, with the vaulted surfaces of the system seven elements unobtrusively blending into the overall room conception. Stand-alone pillars, each labelled in German and English, function at a range of distances to guide visitors to their destinations.



system seven
Erfurt Trade Fair

- 1 Car park identification, customised, 600 x 600 x 600 mm, aluminium and steel, enamelled
- 2 Exterior pillar, 6,000 x 1,450 mm, floodlit by ground-installed spotlight, aluminium, enamelled and anodised
- 3 Exterior pillar, 3,600 x 900 mm, each with four square modules, aluminium, enamelled and anodised
- 4 Directory information pillar as main distribution, 4,800 x 900 mm, aluminium, enamelled and anodised, with stainless steel pedestal
- 5 Ceiling sign, 720 x 2,000 and 720 x 720 mm, vaulted information surfaces, writing on both sides, aluminium
- 6 Mobile pillar »Joker«, 2,000 x 420 mm, with insertable sheets DIN A3 landscape format, for self-labelling

Planning JPH-Erfurt
Photos by Dietmar Wilsche





From a distance visitors are welcomed by the information pillars, which guide them safely to their destinations.

A uniform system of vaulted information elements, from exterior items to directories and signs installed inside, guides the visitors to the permanent target points. Information referring to special events is presented by means of mobile information pillars on which the texts can be varied. Both quick and inexpensive, this also guarantees the uniform appearance of the system.



tube+panel
and tailor-made
Basel Trade Fair, Switzerland

- 1 Large triangular pillar on trade fair site, 5,000 x 1,000 mm, enamelled aluminium surfaces, stainless steel pipes, mobile installation without foundation, interior ballast tank from stainless steel
- 2 Prism ceiling element, permanent text, 300 x 300 x 2,700 mm, aluminium enamelled and anodised, additional signs pointing out special events and adaptor profiles available as add-ons



Large buildings which combine high visitor footfall with continually changing events and uses, pose a challenge to any guiding system. Concise and clear orientation is essential not only for the visitors, but also for the exhibitors, and the potential for flexible application of the informational elements is similarly important. With continually changing content and a variety of locations, solutions are required which can be implemented quickly, cheaply and effectively.

Together with the building owner and the planning team special elements have been developed with flexible plug-in placard and poster holders, with transport rollers which can be sunk into the base for ease of movement.



- 3 Ceiling signs 300 x 900 and 300 x 2,700 mm, writing on both sides, aluminium enamelled and anodised, stainless steel rope system for variable suspension from ceiling
 - 4 Facade element as hall identification, 4,500 x 900 mm, aluminium
 - 5 Mobile triangular pillar, for wheeling, with lockable roller wheels installed inside, aluminium and stainless steel, suitable for installation of placards and posters on three sides.
 - 6 Multifunctional element, for wheeling, runner wheels for sinking into stainless steel pedestal, suitable for installation of placards and posters on both sides, head element removable as quick-change frame
- Planning Heitscher Voss
Graphic design Willie Lindhorst
Photos by Patrick Berniet



Applying the texts via EDP
systems
Pre-cut inlay sheets for laser
printers or inkjet printers
Program for auto-text-
production stored on disk
Optionally individual labelling
masks and graphic designs



Door signs

- 1 **quintessence**
stainless steel,
acrylic glass,
140 x 140 mm
- 2 **system seven**
vaulted fronts,
aluminium,
acrylic glass,
180 x 180 mm
- 3 **tube+panel**
aluminium,
acrylic glass,
150 x 150 mm
- 4 **tube+panel**
stainless steel
vaulted front,
stainless steel,
polycarbon foil,
150 x 100 mm
- 5 **transparence**
aluminium, glass,
120 x 180 mm



As early as 1990, the tube+panel system provided the first uniform signpost system which offered customers the opportunity to develop the required text through their own EDP systems. This has since become the industry standard in signposting systems, at least where door signage is concerned.

In the course of advancing and developing our systems, we have further expanded the customers' opportunity to contribute their own texts. As a result, a considerable range of large-size information media may now be continually, quickly and easily updated by the respective users.

We can provide different DIN-A4 format sheets from foil or fine paper, pre-cut to fit the respective sign sizes. Your required texts can be easily produced on colour printers or laser printers, for example from Word® files. Supported by an optional database software, the contents of complete guiding and orientation systems can be easily managed, supplemented and printed (as Windows® and MacOS® files). In addition to our standard designs, we will happily supply you with individual layouts on demand.

Of course we will continue to offer you our complete text printing service by our graphic design department. Our large-scale digital printing allows for formats up to 1,200 mm wide with photo-realistic colour reproduction.

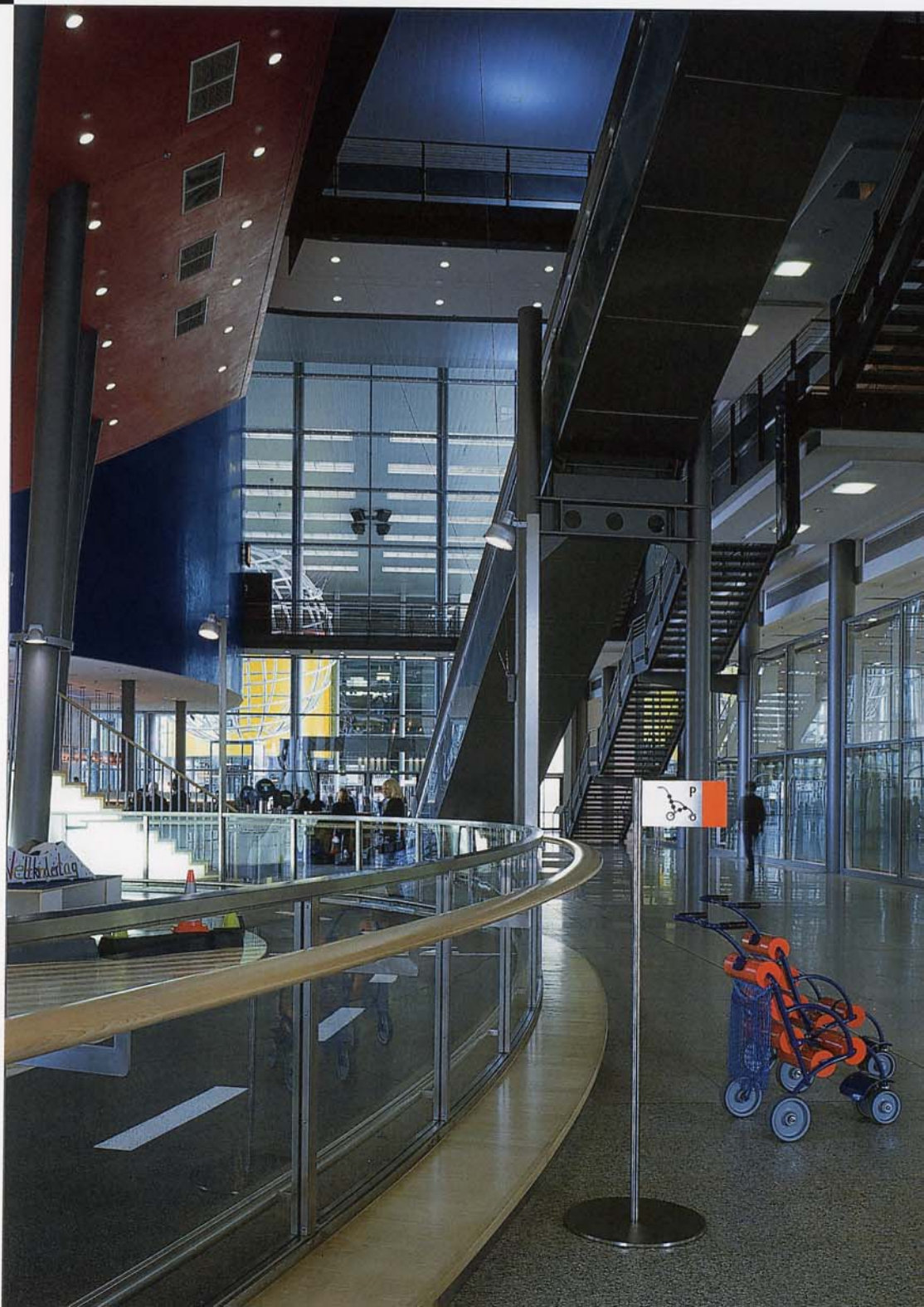



taylor-made element
Glass and stainless steel
»Zeithaus«

VW Autostadt, Wolfsburg

- 1 Cantilevered sign on elevator with colour code and semi-transparent areas
- 2 Mobile pillar on area designed for parking prams, made completely from stainless steel
- 3 Mobile desk pillar and large information pillar with semi-transparent glass elements, screenprint, photo digital print
- 4 Desk pillar for identification of tour route

Planning HZW Multimedia

Photos by Werner Huthmacher



Exhibitions and museums require a large amount of informational media to describe and explain exhibits or methods of operation.

These media elements have to be simple and clear, whilst blending unobtrusively into the environment. They must meet the requirements of being easy to update, while offering the utmost security against handling and interference.



In institutions which may accommodate several companies or frequently changing tenants, the respective sign and guidance systems must be suitable for flexible labelling. Exterior steels, tenants' directories, individual companies' signs and door signs provide a network of information which leads the visitors to their respective destinations.

System quintessence offers a large choice of elements which combine both permanent and temporary information. The basic elements with site plans and general information can be supplemented with additional variable modules for the tenant areas or for other temporary information. The information in these add-ons can be easily changed by the user.

quintessence

Forum Autovision, Wolfsburg

- 1 Large signpost, steel 4,700 x 1,620 mm, stainless steel pedestal, lighting by ground-integrated spotlights
- 2 Signpost steel 3,000 x 1,120 mm, raised individual letters from polished stainless steel, printed foil texts
- 3 Floor directory 1,120 x 840 mm, individual »door sign tiles«, suitable for separate laserprint texts
- 4 Door sign 140 x 140 mm, coloured inlay paper sheet, laserprint text
- 5 Entrance identification, steel 3,000 x 1,120 mm, surface anodised, silver colour, partially enamelled in colour, printed foil texts
- 6 Elevator plate 1,260 x 840 mm, surfaces from anodised aluminium, silver colour, floor identification and site plan as multi-colour screen print

Planning wvz design

Photos by Werner Huthmacher



quintessence
Hôpital Kirchberg
Luxembourg

- 1 Exterior pylon, illuminated from inside at night, 4,800 x 1,190 mm
- 2 Exterior pylon during daytime
- 3 Texts in metal surface created by laser, backed with acrylic
- 4 Wall-mounted direction sign with foil text, 150 x 300 mm
- 5 Surgery sign 500 x 400 mm, permanently labelled head panel with location indication and variable quick-change module for DIN A3 inlays to be designed by user
- 6 Stand-alone survey elements with DIN A3 quick-change module inlays to be designed by user

Photos by Jörg Hempel





The sophisticated architecture of a large hospital with an additional 30 doctors' consulting surgeries poses a special challenge to the orientation system because of the range of different usage aspects involved.

Direction signs in the interior area accommodate frequently changing text information behind acrylic glass, and the patented holder system allows easy updating without any restrictions from the vandal-proof fastening elements.

Exterior pillars set clear and elegant signs, helping to accentuate the company's competence. During daytime the texts and symbols appear black, but after dark they are illuminated. The contrasting effect thus achieved helps to ensure an easy reading at all times.

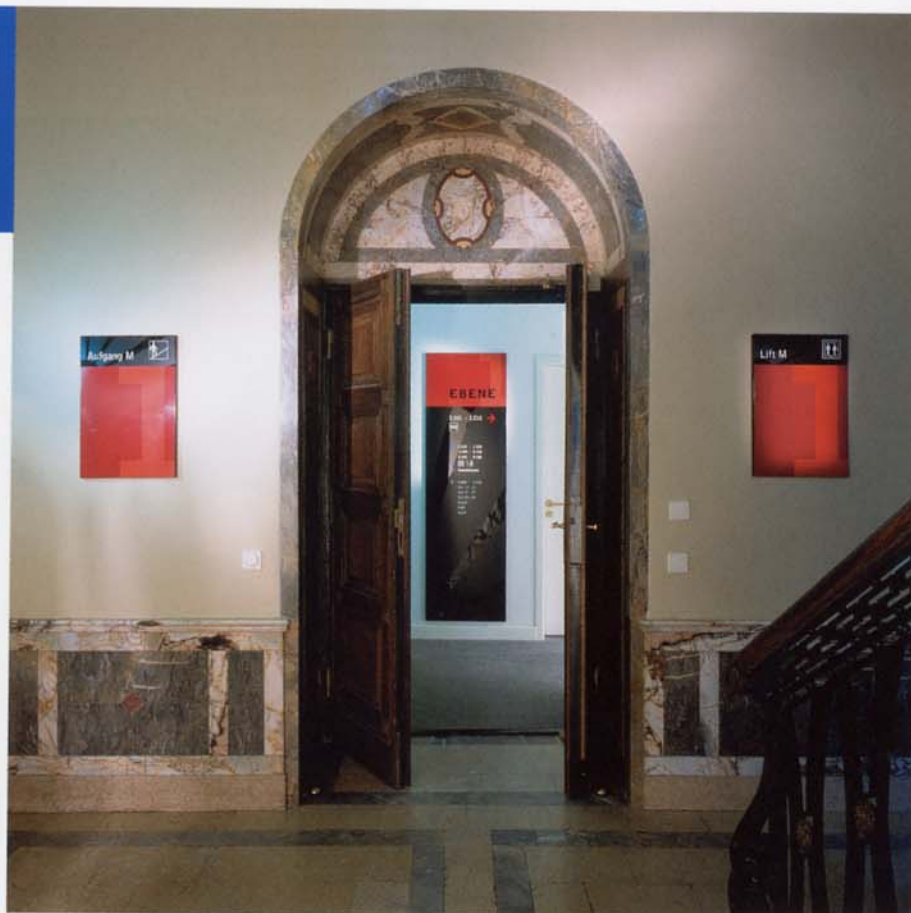

quintessence
SAT.1 Media center, Berlin

- 1 Historical stairwell, floor directory 600 x 400 mm, large main distributor, wall mounted, 2,000 x 600 mm
- 2 Stairwell situation with floor identification, main distributor coloured in accordance with picture »Green Impression with Poppy«
- 3 Hub situation, glossy and matted screen print, changeable high-performance foil text
- 4 Wall sign in combination with »Blue Impression«
- 5 Corridor axis towards entrance hall, elevator anteroom
- 6 Reception, entrance hall, mobile stand-alone signpost, 2,000 x 600 mm
- 7 Entrance, stand-alone signpost, stainless steel edges and foot-plate

Design by SAT.1 Design & Grafik
Impressions: Gabriele Stieghorst
Photos by Werner Huthmacher

Companies and enterprises continually grow and expand, new buildings supplement historical structures, and evolving organisations move to new locations. Especially in the case of expansions resulting from restructuring and relocation, colour will help provide orientation and create a consistency of identity.

The dialogue between old and new, renovated old buildings and modern structures, is supported by the guiding system. The clear and simple elegant lines of the information elements create harmony.



The elements of the transparenze range use modern and minimalist lines, creating a clear information structure. Design and material are perfectly attuned to match modern architecture or to provide an effective counterpoint to historical buildings.

Even the most versatile sign system will be unable to cater to every situation. We can provide customised solutions to solve unusual challenges, no matter whether these need to fit in smoothly with a sign system, or be developed in free design, or adapted to existing architecture. Even digital information elements such as screen terminals and electronic door signs can be easily integrated due to the modular character of the sign system.

Of course, alongside our innovative detailed solutions, such attributes as quality, durability, stability and safety come as standard.





transparence

Kreissparkasse Birkenfeld,

- 1 Door sign 180 x 90mm, inlay foil suitable for laser printing

Photo by Igel Studios

Stadtwerke Düsseldorf

- 2 Glass columns, 2,000 x 600 mm, Compound safety glass, opaque, 12 mm, text on printed foil

International University

Bremen

- 3 Information columns with two parallel compound safety glass panels, text on both sides, 2,700 x 600 mm,

Photo by Jens Meier, Bremen

tailor-made

JTI, Trier

- 4 Screen terminal quintessence, mobile element, 2,200 x 420 mm, 17"-TFT screen (43 cm),

Photo by Oliver Götz, Schweich

Wholesale Bremen

- 5 Company logo, illuminated from inside

Photo by Jens Meier, Bremen

Kreissparkasse Birkenfeld

- 6 Object column illuminated from inside, cut out texts, clock and temperature indication

Photo by Igel Studios

Developing profiles
Metal processing
Plastic processing
Metal workshop
CNC-cutting
CNC-folding
Enamelling and painting
Screen printing
Digital printing
Foil plotting service

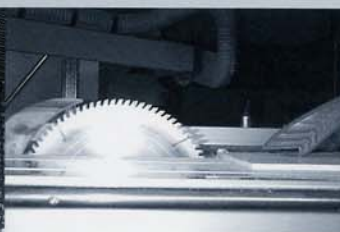



With the very first steps taken in the course of producing our first own sign system, ecological and economical aspects were raised and dealt with. For the production of the components, only top quality material with a long life-cycle is employed, which is suitable for unproblematic recycling in the future.

Our spraypainting department is equipped with an extractor system which grants optimal fresh air supply for our staff and for the surfaces of enamelled elements which are thus unblemished by dust or pollen.

We employ modern CNC-technology for cutting the board material, which provides us with efficient and economical production. The products are then fitted with especially developed profiles from our large profile stock.

The centre for processing metal sheet offers the highest precision with CNC-controlled folding technology, both for individual and unique items or for series production.

Our text writing department offers capacities for screen print involving over 3000 different colour formulas, for example in accordance with RAL, Pantone, NCS or HKS. In combination with the digital print procedure, which is especially suited for picture reproduction and autotype modes, computer-cut high-performance foils are also available, so we can provide you with a wide range of efficient solutions, adapted to each respective intended application.

Meng Informationstechnik GmbH
Am Bahnhof 8
D 55765 Birkenfeld

Telephone ++49 (0) 6782 9941-0
Telefax ++49 (0) 6782 9941-41
eMail info@meng.de
Online www.meng.de



Meng Informationstechnik services and products are available not only all over Germany, but also in many European countries.

Our highly expert consultants will support you at your working premises whilst planning your guiding and signage system, working together with you to develop a customised solution to suit your individual requirements. Your projects will be achieved on a basis of effective planning, executed by skilled and motivated staff in our state-of-the-art production plant. Quick and unproblematic installation and servicing are guaranteed.

Our work is characterised by competence, quality and promptness.

Meng Informationstechnik GmbH

ESPECIALISTAS EM CONSTRUÇÃO DE INTERIORES

Tel.: 21 9677460 - Fax: 21 9677479

info@eurodivisal.com
www.eurodivisal.com

2725-505 Mem Martins - Portugal

R da Esperança, nº.17 - Br das Raposeiras